



**Applications**

- Uninterruptible Power Supply (UPS)
- Electric Power System (EPS)
- Emergency Light
- Golf cart, Electric vehicle
- Railway signal system
- Marine and power stations
- Aircraft signal system
- Alarm and security system
- Electronic apparatus and equipment
- Electric powered bicycle & Wheelchair
- Communication power supply
- Solar powered systems

**Battery Construction**

COMPONENT	POSITIVE PLATE	NEGATIVE PLATE	CONTAINER	COVER	SAFETY VALVE	TERMINAL	SEPARATOR	ELECTROLYTE
Raw material	Lead dioxide	Lead	ABS	ABS	Rubber	Copper	PVC/SiO <sub>2</sub>	Gelled Acid

**Performance Characteristics**

- **Nominal Voltage** ..... 12V
- **Number of Cell** ..... 6
- **Nominal Capacity (77°F /25°C)**
  - 100 Hour rate (1.55A, 10.8V) ..... 155Ah
  - 20 Hour rate (6.5A,10.8V) ..... 130Ah
  - 10 Hour rate (12A,10.8V) ..... 120Ah
  - 5 Hour rate (20.4A, 10.5V) ..... 102Ah
- **Internal Resistance**
  - Fully charged battery (77°F /25°C) ..... 7.5mΩ
- **Capacity affected by temperature (10 hour rate)**
  - 104°F (40°C) ..... 102%    32°F (10°C) ..... 85%
  - 77°F (25°C) ..... 100%    5°F (-15°C) ..... 65%
- **Self-Discharge 68°F (20°C)**
  - Capacity after 3 month storage ..... 90%
  - Capacity after 6 month storage ..... 80%
  - Capacity after 12 month storage ..... 60%
- **Max. discharge current 77°F /25°C** ..... 625A(5S)
- **Charge Methods: constant voltage charge 77°F /25°C**
  - Cycle use ..... 14.28 ~ 14.52V
  - Max. Current ..... 26A
  - Standby use ..... 13.38 ~ 13.62V

**General Features**

- **Micro millimeter SiO<sub>2</sub> and H<sub>2</sub>SO<sub>4</sub> technology for efficient gas recombination of up to 99%.**
- **Maintenance free and no water adding required.**
- **Not restricted for air transportation as Nollon Battery complies with IATA/ICAO special provision A67.**
- **Raw material used in Nollon battery is of CE and UL (MH49077) standards.**
- **Computer designed lead-calcium tin plate grid alloy provides high power density and less gassing.**
- **ABS case (optional for Fire Retardant case).**
- **Strong ability to recover from deep discharging and has 50% more deep cycle life.**
- **Spill/leak proof and vibration resistant.**
- **Long service life for float or cyclic applications.**
- **Design life 12 years**

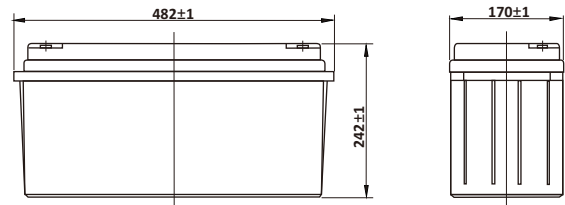

**Dimensions and Weight**

Type	Length	Width	Height	Total Height	Approx. Weight
<b>SI Units</b>	482mm	170mm	242mm	242mm	46Kg
<b>English Units</b>	19inch	6.69inch	9.53inch	9.53inch	101.4lbs

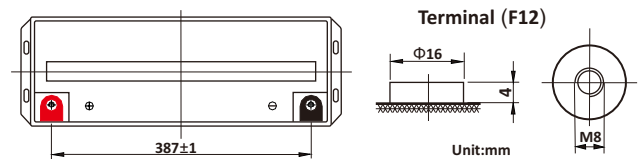

**Constant Current Discharge (Amperes at 77°F/25°C)**

V/cell	10min	15min	30min	1h	3h	5h	10h	20h	100h
1.60	265	202	125	72.0	32.8	22.0	12.4	6.75	1.62
1.65	253	194	120	71.0	32.2	21.6	12.4	6.70	1.60
1.70	239	184	114	69.5	31.5	21.1	12.3	6.65	1.58
1.75	224	174	108	68.0	30.7	20.4	12.2	6.60	1.57
1.80	206	162	100	66.0	29.7	19.8	12.0	6.50	1.55

**Constant Power Discharge (Watts/cell at 77°F/25°C)**

V/cell	10min	15min	30min	45min	1h	2h	3h	5h	100h
1.60	450	380	230	180	143	78.0	58.1	40.8	3.18
1.65	428	365	223	176	141	76.5	57.2	40.1	3.14
1.70	403	347	213	170	139	74.5	56.0	39.3	3.13
1.75	375	327	203	164	136	72.5	54.7	38.5	3.12
1.80	345	305	190	156	132	70.0	53.2	37.5	3.10

(Note: The above characteristics data are average values obtained within three charge/discharge cycles not the minimum values.)

